

FIXTURE TYPE \_\_\_\_\_

PROJECT NAME \_\_\_\_\_

LOCATION \_\_\_\_\_



# Zolo™ 3

ULTRA-THIN LED WASHER/GRAZER



## I Description

Zolo 3 is an interior washer/grazer with a small form factor, great light output, and is highly customizable to perfectly fit your project.

## I Features

- Multiple Optics Options Available
- Extruded Aluminum Alloy Housing
- Available in Titanium Gray, Black, or White Finish
- Multi-Volt 24VDC Remote Driver (Sold Separately)
- Daisy Chain Multiple Fixtures
- Optional Glare Control Accessories

## I Specifications

Input Voltage	24V DC/Constant Voltage
Watts per Foot	6W/ft*
Lumen per Watt	100 lm/W
Lumen per Foot	600 lm/ft
Beam Spread	20°, 30°, 20°x40°, 60°, 80°
Max Run Length	16ft
CRI	85*
Operating Temp.	-40°F (-40°C) to 140°F (60°C)
Storage Temp.	-4°F (-20°C) to 140°F (60°C)
Dimming Options	Non-dimmable (Consult Factory for dimmable fixtures)

## I Product Code Builder

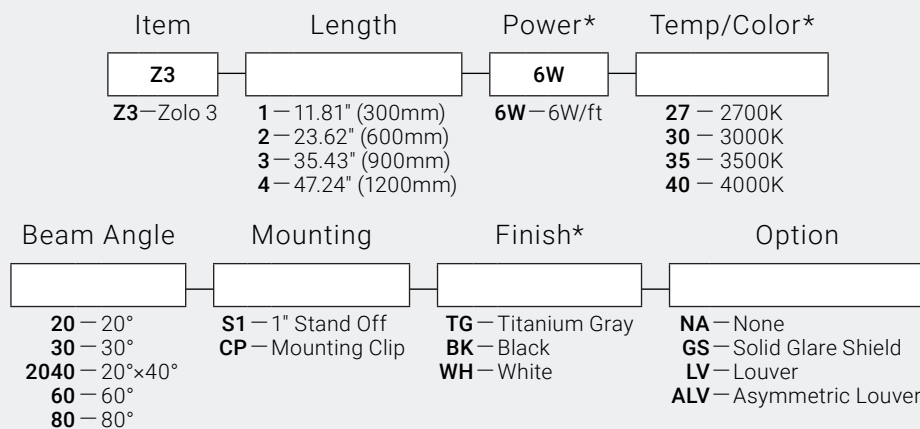

Example: Z3-1-6W-27-20-S1-TG-NA

\* Customizable—Consult Factory



## Dimensions

Length	11.81" (300mm), 23.62" (600mm), 35.43" (900mm), 47.24" (1200mm)
Width	1.02" (26.0mm)
Height	0.83" (21.0mm)

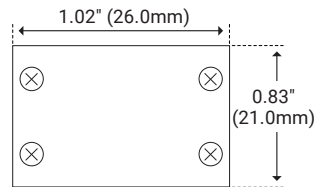
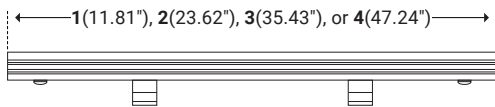

## Mounting

### 1" Stand Off



Unit Number	Z-03-S1
Ordering Code	S1
Length	0.70" (18.0mm)
Width	1.25" (32.0mm)
Stand Off Height	1.06" (27.0mm)
Rotation	70°

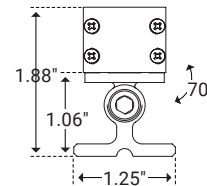

### Mounting Clip



Unit Number	Z-03-CP
Ordering Code	CP
Length	0.79" (20.0mm)
Width	0.70" (17.7mm)
Stand Off Height	0.45" (11.5mm)

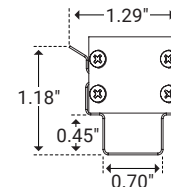

## Options

### Solid Glare Shield

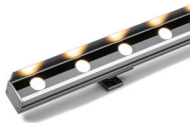

Unit Number	Z-03-GS
Ordering Code	GS
Width	1.02" (26.0mm)
Height	1.46" (37.0mm)

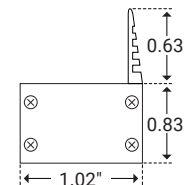

### Louver



Unit Number	Z-03-LV
Ordering Code	LV
Louver Width	1.20" (30.5mm)
Louver Height	0.51" (13.0mm)
Overall Height	1.04" (26.5mm)

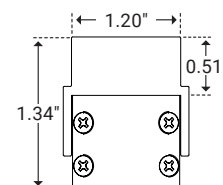



## Options

### Asymmetric Louver



Unit Number	Z-03-ALV
Ordering Code	ALV
Louver Width	1.20" (30.5mm)
Louver Height	0.51" (13.0mm)
Overall Height	1.04" (26.5mm)

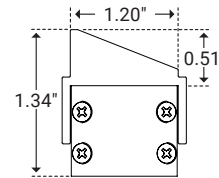

## Power & Connectors Options

### Power Lead



Unit Number	Length
Z-03-FML-6	6ft
Z-03-FML-20	20ft
Z-03-FML-50	50ft

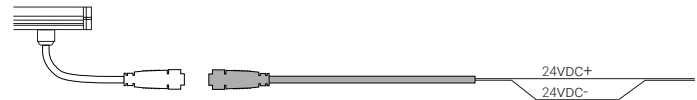

### Connector



Unit Number	Length
Z-03-FMC-1	1ft
Z-03-FMC-2	2ft
Z-03-FMC-6	6ft

