

FIXTURE TYPE \_\_\_\_\_

PROJECT NAME \_\_\_\_\_

LOCATION \_\_\_\_\_



## Zolo™ 5

SLIM INDOOR/OUTDOOR  
LED WASHER/GRAZER



## Description

Zolo 5 is our most popular indoor/outdoor washer/grazer. With its small form factor, great light output, and high customizability, it's sure to fit your project perfectly.

## Features

- High Purity Tempered Glass
- Extruded Aluminum Alloy Housing
- Available in Titanium Gray, Black, or White Finish
- Multi-Volt 24VDC Remote Driver (Sold Separately)
- Daisy Chain Multiple Fixtures
- IP66 Outdoor Rated
- Louver Options Available

## Specifications

Dimming Options	PWM, Triac, 0–10V, DMX 512, ELV
Input Voltage	24V DC/Constant Voltage
Watts per Foot	8W/ft*
Lumen per Watt	100 lm/W
Lumen per Foot	800 lm/ft
Beam Spread	25°, 30°, 50°, 25°×40°, 30°×55°
Max Run Length	12 ft
CRI	85*
Operating Temp.	-40°F (-40°C) to 140°F (60°C)
Storage Temp.	-22°F (-30°C) to 140°F (60°C)

## Product Code Builder

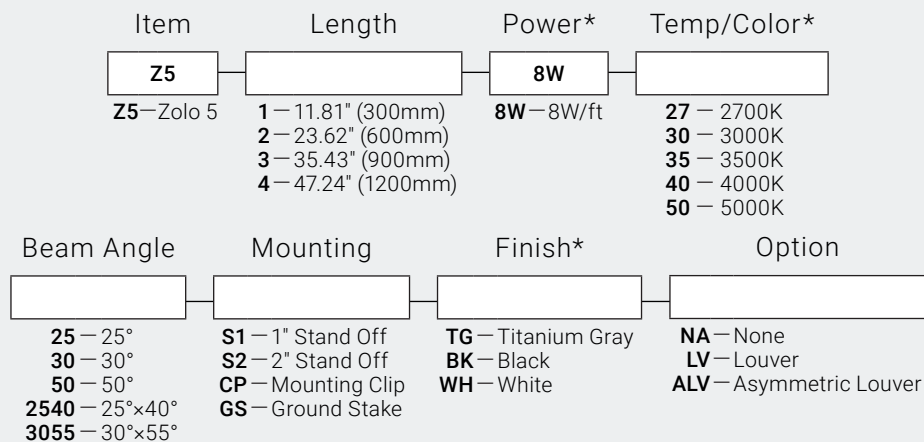

Example: Z5-1-8W-27-25-S1-TG-NA

\* Customizable—Consult Factory



## Dimensions

Length	11.81" (300mm), 23.62" (600mm), 35.43" (900mm), 47.24" (1200mm)
Width	1.30" (33.0mm)
Height	1.08" (27.5mm)

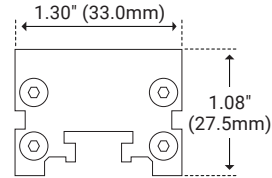
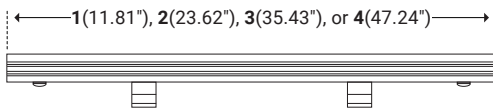

## Mounting

### 1" Stand Off



Unit Number	Z-05-S1
Ordering Code	S1
Length	0.71" (18.0mm)
Width	1.26" (32.0mm)
Stand Off Height	1.13" (28.7mm)
Rotation	75°

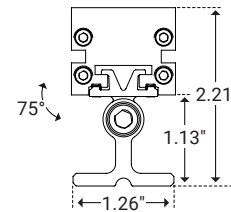

### 2" Stand Off



Unit Number	Z-05-S2
Ordering Code	S2
Length	0.71" (18.0mm)
Width	1.65" (42.0mm)
Stand Off Height	2.24" (57.0mm)
Rotation	105°

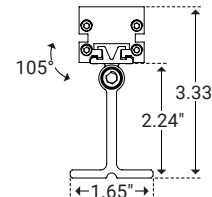

### Mounting Clip



Unit Number	Z-05-CP
Ordering Code	CP
Length	1.18" (30.0mm)
Width	0.98" (25.0mm)
Stand Off Height	0.67" (17.0mm)

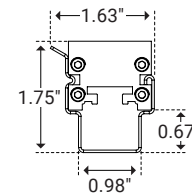

### Ground Stake



Unit Number	Z-05-GS
Ordering Code	GS
Diameter	ø2.05" (52.1mm)
Stand Off Height	9.51" (241.6mm)
Rotation	95°

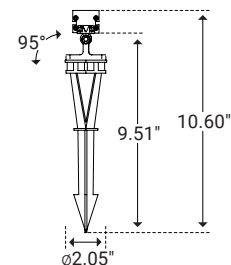



## I Options

### Louver



Unit Number	Z-05-LV
Ordering Code	LV
Louver Width	1.46" (37.0mm)
Louver Height	0.39" (10.0mm)
Overall Height	1.18" (30.0mm)

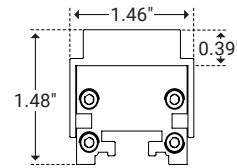

### Asymmetric Louver



Unit Number	Z-05-ALV
Ordering Code	ALV
Louver Width	1.46" (37.0mm)
Louver Height	0.39" (10.0mm)
Overall Height	1.18" (30.0mm)

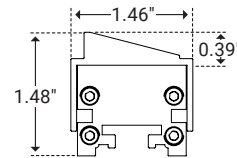

## I Power & Connectors Options

### Power Lead



Unit Number	Length
Z-57-FML-6	6ft
Z-57-FML-20	20ft
Z-57-FML-50	50ft



### Connector



Unit Number	Length
Z-57-FMC-1	1ft
Z-57-FMC-2	2ft
Z-57-FMC-6	6ft



### End Cap



Unit Number	Z-57-EC
-------------	---------

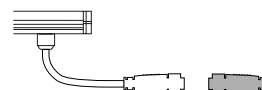

# | Wiring Options

## Primary Side Dimming (120V Only)

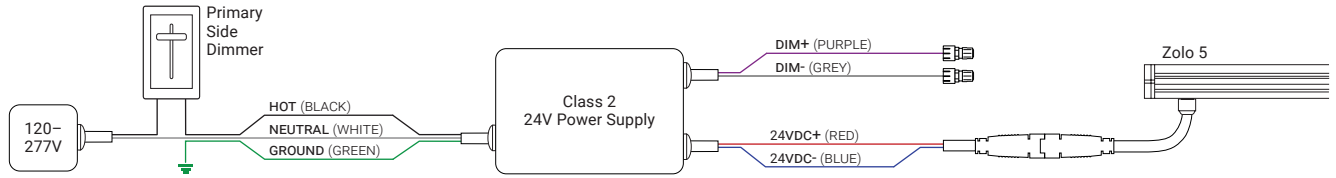

## Primary Side Switching (120-277V)

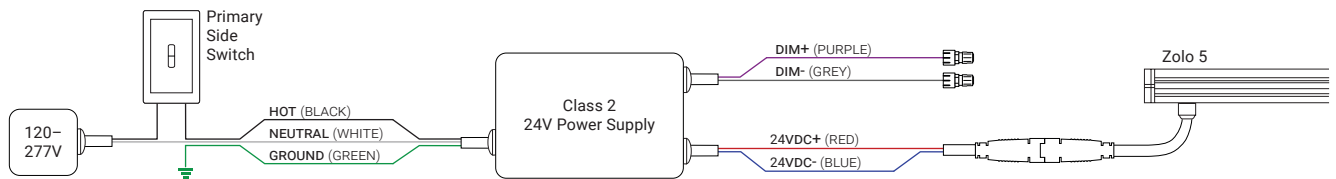

## 0-10V Dimming (120-277V)

