

FIXTURE TYPE \_\_\_\_\_

PROJECT NAME \_\_\_\_\_

LOCATION \_\_\_\_\_



## Zolo™ 7

INDOOR/OUTDOOR LED  
WASHER/GRAZER



## I Description

Zolo 7 is our brightest outdoor rated washer/grazer. While remaining slim, Zolo 7 offers 1100 lumens a foot! With multiple beam angles, kelvin temperatures, colors, and accessories Zolo 7 can light any project.

## I Features

- High Purity Tempered Glass
- Extruded Aluminum Alloy Housing
- Available in Titanium Gray, Black, or White Finish
- Multi-Volt 24VDC Remote Driver (Sold Separately)
- Daisy Chain Multiple Fixtures
- IP66 Outdoor Rated
- Louver Options Available

## I Specifications

Dimming Options	PWM, Triac, 0–10V, DMX 512, ELV
Input Voltage	24V DC/Constant Voltage
Watts per Foot	11W/ft*
Lumen per Watt	100 lm/W
Lumen per Foot	1100 lm/ft
Beam Spread	10°×50°, 25°×40°, 15°, 30°
Max Run Length	8 ft
CRI	85*
Operating Temp.	-40°F (-40°C) to 140°F (60°C)
Storage Temp.	-22°F (-30°C) to 140°F (60°C)

## I Product Code Builder

Item	Length	Power*	Temp/Color*
<b>Z7</b> Z7—Zolo 7	<b>1</b> —12.32" (313mm) <b>2</b> —23.81" (605mm) <b>3</b> —35.43" (900mm) <b>4</b> —46.85" (1190mm)	<b>11W</b> —11W/ft	<b>27</b> —2700K <b>30</b> —3000K <b>35</b> —3500K <b>40</b> —4000K
Beam Angle	Mounting	Finish*	Option
<b>1050</b> —10°×50° <b>2540</b> —25°×40° <b>15</b> —15° <b>30</b> —30°	<b>S2</b> —2" Stand Off <b>S3</b> —3" Stand Off <b>CP</b> —Mounting Clip <b>GS</b> —Ground Stake <b>L3</b> —L Bracket	<b>TG</b> —Titanium Gray <b>BK</b> —Black <b>WH</b> —White	<b>NA</b> —None <b>LV</b> —Louver <b>ALV</b> —Asymmetric Louver

Example: Z7-1-11W-27-1050-S2-TG-NA

\* Customizable—Consult Factory



## Dimensions

Length	12.32" (313mm), 23.81" (605mm), 35.43" (900mm), 46.85" (1190mm)
Width	1.97" (50.0mm)
Height	1.35" (34.4mm)

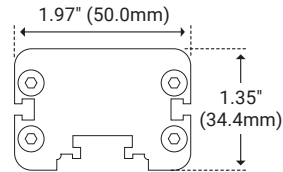
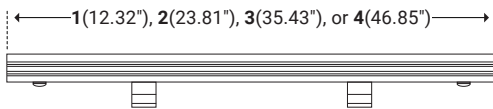

## Mounting

### 2" Stand Off



Unit Number	Z-07-S2
Ordering Code	S2
Length	1.18" (30.0mm)
Width	2.36" (60.0mm)
Stand Off Height	1.87" (47.4mm)
Rotation	90°

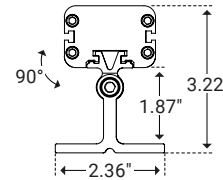

### 3" Stand Off



Unit Number	Z-07-S3
Ordering Code	S3
Length	1.18" (30.0mm)
Width	2.36" (60.0mm)
Stand Off Height	2.63" (66.9mm)
Rotation	105°

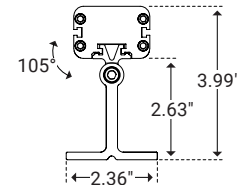

### Mounting Clip



Unit Number	Z-07-CP
Ordering Code	CP
Length	0.98" (25.0mm)
Width	1.35" (34.3mm)
Stand Off Height	0.67" (17.0mm)

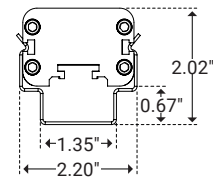

### Ground Stake



Unit Number	Z-07-GS
Ordering Code	GS
Diameter	ø2.05" (52.1mm)
Stand Off Height	9.64" (244.8mm)
Rotation	70°

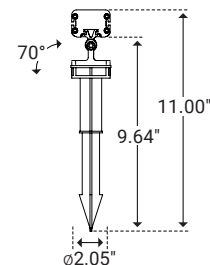



## I Mounting

### L Bracket



Unit Number	Z-07-L3
Ordering Code	L3
Foot Length	1.18" (30.0mm)
Foot Width	2.36" (60.0mm)
Stand Off Height	2.67" (67.9mm)

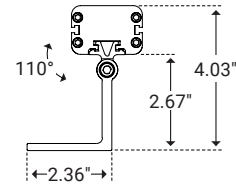

## I Options

### Louver



Unit Number	Z-07-LV
Ordering Code	LV
Louver Width	2.14" (54.3mm)
Louver Height	0.79" (20.0mm)
Overall Height	1.34" (33.0mm)

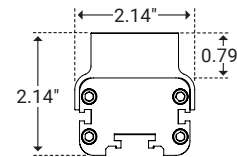

### Asymmetric Louver



Unit Number	Z-07-ALV
Ordering Code	ALV
Louver Width	2.14" (54.3mm)
Louver Height	0.79" (20.0mm)
Overall Height	1.34" (34.0mm)

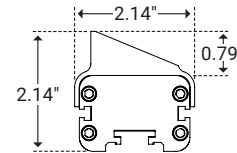

## I Power & Connectors Options

### Power Lead



Unit Number	Length
Z-57-FML-6	6ft
Z-57-FML-20	20ft
Z-57-FML-50	50ft



### Connector



Unit Number	Length
Z-57-FMC-1	1ft
Z-57-FMC-2	2ft
Z-57-FMC-6	6ft



### End Cap



Unit Number	Z-57-EC
-------------	---------

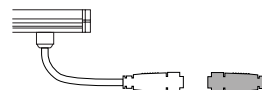



## | Wiring Options

### Primary Side Dimming (120V Only)

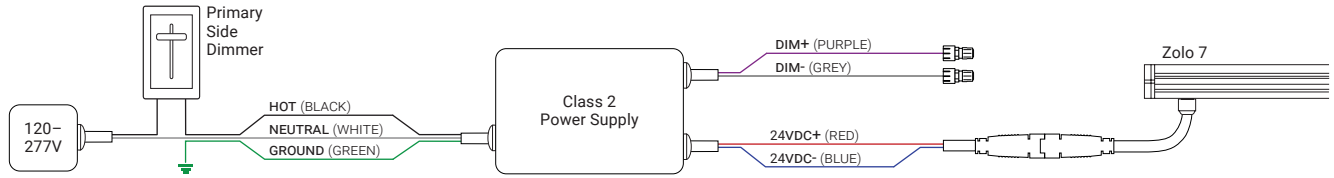

### Primary Side Switching (120-277V)

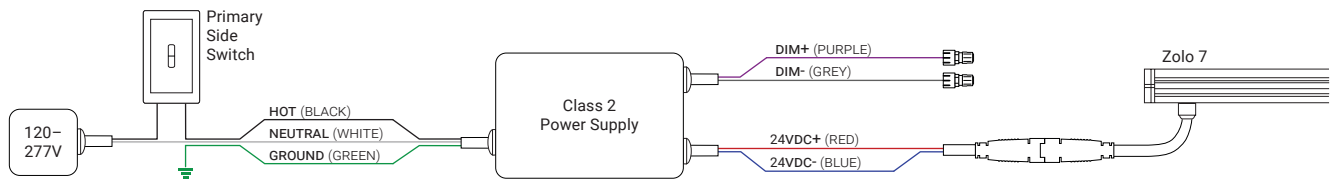

### 0-10V Dimming (120-277V)

